

Y PIN NORMAL PRESSURE GAUGE



(Application Description)

This kind of axial pressure gauge is well suited for measuring those gasses or liquids which will neither explode nor crystallize, nor precipitate, nor corrode copper or copper alloys.

Main Technology Data

Name	Model	Nominal Diameter (mm)	Accuracy	Measuring range(Mpa)	Connection	Mouting Dimension
General pressure gauge	Y-40	Φ40	2.5	0.1 , 0.16 0.25 , 0.4 0.6 , 1 , 1.6 2.5 , 4 , 6 , 10 16 , 25 , 40 60 , 100 -0.1~0 , -0.1 ~0.06 -0.1~0 , -0.1 ~0.3 -1~0.5 , -1~ 0.9 -0.1~1.5 , - 0.1~2.4	M10×1	-
	Y-60	Φ60	2.5		M14×1.5	-
	Y-100	Φ100	1.5		M20×1.5	-
	Y-150	Φ150	1.5		M20×1.5	-
	Y-200	Φ200	1.5		M20×1.5	-
	Y-250	Φ250	1.5		M20×1.5	-
Radial Pressure gauge With rear margin	Y-60T	Φ60	2.5	M10×1 M14×1.5	Φ72×120 3- Φ5	
	Y-100T	Φ100	1.5	M20×1.5	Φ118×120 3-Φ	
	Y-150T	Φ150	1.5	M20×1.5	Φ165×120 3-Φ56	
Axial pressure gauge with front margin	Y-60ZT	Φ60	2.5	M10×1 M14×1.5	Φ72×120 3- Φ5	
	Y-100ZT	Φ100	1.5	M20×1.5	Φ118×120 3-Φ6	
	Y-150ZT	Φ150	1.5	M20×1.5	Φ165×120 3-Φ6	
Axial pressure gauge Without margin	Y-40Z	Φ40	2.5	M10×1	-	
	Y-60Z	Φ60	2.5	M10×1 M14×1.5	-	
	Y-100Z	Φ100	1.5	M20×1.5	-	
	Y-150Z	Φ150	1.5	M20×1.5	-	
Hi-tempeure	Y-60T	Φ60	2.5	M14×1.5	-	

Resistance pressure gauge	Y-100T	Φ100	1.5		M20×1.5	-
	Y-150T	Φ150	1.5		M20×1.5	-

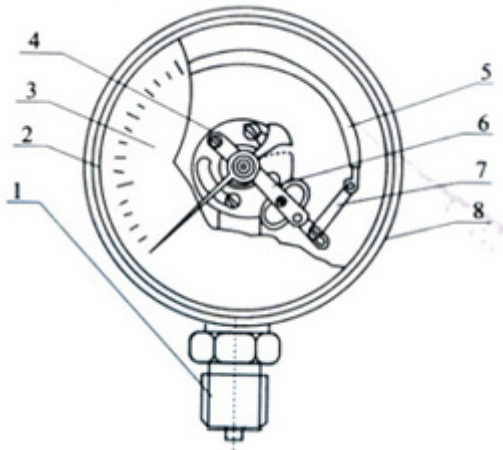

Overall Dimensions

- 1、 joints
- 2、 bush
- 3、 dial
- 4、 index
- 5、 spring tube
- 6、 gearbox(core)
- 7、 connecting rod
- 8、 watchcase

Radial installation directly
(Y-40 , 60 , 100 , 150 , 200 , 250)

Axial installation
(Y-60ZT , 100ZT , 150ZT)

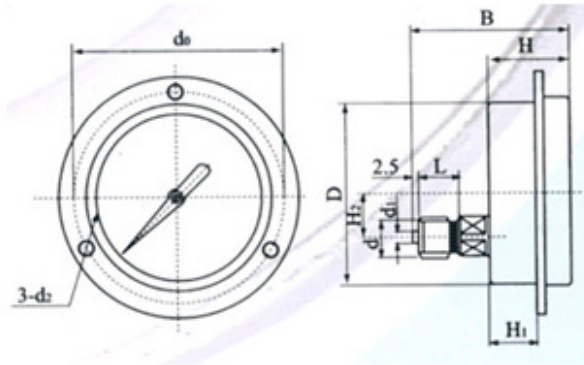
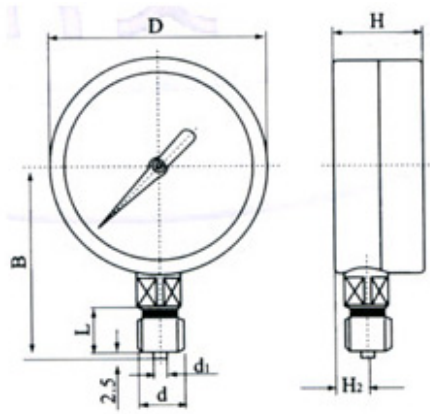



Y40 1/4



Y40 1/8



Y40 1/8



Y40 1/4



Y40 1/8



Y40 1/8



Y40 1/4



Y40 1/8



Y40 1/8



Y40T 1/8



Y50 1/4



Y50 1/4



Y50 1/4



Y50 1/4



Y60 M10x1



Y60 M10



Y60T 1/4



Y60T 1/8



Y40 1/8



Y40 1/8



Y40 1/8